



HSM2HOST 2-Way Wireless Transceiver Installation Manual



Contents

Introduction.....	5
Installation Process Overview.....	5
Controls and indicators.....	5
Status LEDs.....	5
Tamper.....	6
Safety instructions.....	7
Specifications and features.....	8
Compatible wireless devices.....	9
Installing the HSM2HOST.....	11
Temporary mounting requirements.....	11
Connecting the HSM2HOST to the alarm panel.....	11
Enrolling The HSM2HOST.....	12
Enrolling the HSM2HOST without a hardwired keypad.....	12
Enrolling the HSM2HOST with an enrolled hardwired keypad.....	12
Enrolling the HSM2HOST with only unenrolled hardwired keypads.....	12
Permanently mounting the HSM2HOST and wireless devices.....	12
Other Options.....	13
Enrolling and programming wireless devices.....	14
[804][000] Enrolling wireless devices.....	14
[804][001]-[716] Wireless Device Configuration.....	14
[804][801] RF Jam Detect.....	15
[804][802] Wireless supervisory time window.....	15
[804][810] Wireless Option 1.....	16
[804][841] Motion cameras.....	17
[804][901]-[905] Deleting wireless devices.....	17
[804][921]-[925] Replacing wireless devices.....	17
[804][990][001 – 005] Show all devices.....	18
[804][999] Reset to factory defaults.....	18
[904] Placement testing of wireless devices.....	18
Programming Worksheets.....	20
[804] Wireless programming.....	20
[804][000] Wireless Device Enrollment – Zones.....	21
[804][000] Wireless device enrollment – Wireless keys.....	22
[804][000] Wireless device enrollment – Wireless keypads.....	22
[804][000] Wireless device enrollment – Wireless repeaters.....	23
[804][001]-[128] Configure wireless zones 1-128.....	23
[804][551]-[566] Configure wireless sirens 1-16 (copy as needed).....	25
[804][601]-[632] Configure Wireless Keys (copy as needed).....	26
[601]-[632] Wireless Key 1-32.....	26
[804]-[701]-[716] Wireless Keypad Programming.....	27

[804][841] Motion Cameras.....	30
[804][901]-[905] Delete Wireless Devices.....	30
[804][921]-[925] Replace Wireless Devices.....	30
[804][990] Show All Devices.....	31
LIMITED WARRANTY.....	32
FCC Compliance Statement.....	39
IC Statement.....	39
EU Compliance Statement.....	39

Introduction

About this task:

The HSM2HOSTx two-way wireless transceiver adds wireless capability to alarm controllers, models HS2016, HS2032, HS2064, HS2128, HS3128, HS3032. The HSM2HOST receives signals from wireless zones and wireless keys, and provides information to the alarm controller. This manual describes how to install, program and maintain the HSM2HOST.

Note: Only one HSM2HOST or one RFK keypad can be enrolled on the alarm system. Before installing complete the following steps:

1. Plan the placement and wiring of the security system (see system installation manual).
2. Install the control panel and optional modules.
3. Temporarily mount all wireless devices in the intended location.

Installation Process Overview

About this task:

To install and set up the HSM2HOST and wireless devices:

1. Temporarily mount and wire the HSM2HOST module (See "Mounting").
2. Enroll the HSM2HOST and the first wireless keypad (See "Enroll The HSM2HOST").
3. Check the location for RF interference levels (See "[804][801] RF Jam Detect").
4. Enroll wireless devices (See "[804][000] Enroll Wireless Devices").
5. Complete zone and other programming on the system (See "Wireless Device Setup and Programming").
6. Test the placement of all the wireless devices (See "[904] Placement Testing Wireless Devices").
7. Permanently mount the HSM2HOST and wireless devices (See "Permanently Mount").

Controls and indicators

Status LEDs

The LEDs on the front of the HSM2HOST provide feedback regarding the installation, operation and troubleshooting of the unit. The LEDs function as follows:

Table 1: Status LEDs

Red LED	Operation
Module Power Up:	On steady during module power-up sequence then off.
Firmware Update:	Slow flashing = update in progress Rapid flashing = update failed
Trouble Condition:	<ul style="list-style-type: none">• No trouble: 1 rapid flash every 10 seconds. If troubles are present, a series of flashes occur every 2 seconds. Each series of flashes indicate troubles as follows: <ul style="list-style-type: none">• 1 flash: Module not enrolled• 2 flashes: Loss of contact with module for over 60 seconds• 3 flashes: Corbus low voltage• 8 flashes: RF interference (jam condition)

Table 1: Status LEDs

Red LED	Operation
Module Confirmation:	Flashes rapidly during module confirmation process.
Placement Test:	On steady when location is unsuitable. Off when location is suitable.
Green LED	Operation
Placement Test:	On steady when location is suitable. Off when location is unsuitable. ⓘ Note: For UL/ULC listed systems, signal must be Strong. See Wireless Device Status Indications for details.

Tamper

The HSM2HOST has built-in wall and case tampers. The tamper function is disabled by default on the NA version (enabled on the EU version). The tamper function can be enabled or disabled in Option 3, [804][810] [Wireless Option 1](#). The case tamper activates when the case is opened and restores when the case is closed. The wall tamper on the back of the unit is depressed by the mounting surface when properly installed. If the unit is removed, the tamper activates. Ensure the mounting surface is smooth and free of obstructions that block access to the rear of the unit. Electrical wires should not run over or under the module when it is mounted.

- ⓘ **Note:** The built-in wall and case tamper must be installed and enabled for UL/ULC listed Commercial/ Residential Burglary applications.

Safety instructions

Read the safety information before you install the equipment.

- ▶ **Important:** This equipment must be installed by a skilled person only. A skilled person is an installer with appropriate technical training. The installer must be aware of potential hazards during installation and measures available to minimize risks to the installer and other people.
- Before you install this equipment, disconnect all power sources (for example mains, battery, and telephone line) connected to the alarm panel.
- Install the equipment indoors in a non-hazardous environment where the following conditions are met:
 - Pollution degree - Maximum 2
 - Over voltages - Category II
- Internal wiring must be routed to prevent strain on wire and terminal connections, loose terminal connections, and damage to conductor insulation.
- Instruct the user that there are no user serviceable parts in this equipment. All equipment must be serviced by a skilled person.

Specifications and features

- Current Draw: 60mA
 - Voltage: Draws current from the PowerSeries Neo or PowerSeries Pro alarm controller (10.8VDC to 12.5VDC) - (Limited Power Supply)
 - Frequency: 433MHz (HSM2HOST4), 868MHz (HSM2HOST8), 912-919MHz (HSM2HOST9^{UL})
 - Zones - can receive signals from up to 128 wireless zones, and 16 wireless keypads
 - Supports up to 32 wireless keys or 32 panic pendants
 - Supervisory - programmable supervisory window
 - Can be wired up to 1000 ft. / 230 m from the main panel with 22 AWG wire
 - Connects to Corbus
 - Compatibility: The HSM2HOST is used with PowerSeries Neo or PowerSeries Pro alarm panels
 - Operating temperature: NA= 0°C to +49°C (32°F to 122°F); EU= -10°C to +55°C
 - Relative humidity: 93% non-condensing
 - Built-in wall and case tampers
- ① **Note:** For Commercial BURG (UL) the Supervisory window shall be set to 4 hours. For Residential Fire (UL/ULC) the Supervisory window shall be set to 200 seconds. For Residential BURG (UL/ULC) the supervisory window shall be set to 24 hours. For UL Home Healthcare applications the supervisory window shall be set to 24 hours Only models operating in the band 912-919 MHz are UL/ULC listed where indicated. Only UL approved devices are to be used with UL/ULC listed systems.

Compatible wireless devices

The HSM2HOSTx (x= 4/8/9) can receive signals from the devices listed in the following table. For more information, refer to the individual device instruction sheet.

① **Note:** Throughout this document, x in the model number represents the operating frequency of the device for one of the following models: 9 (912-919 MHz), 8 (868MHz), 4 (433MHz).

Table 2: Compatible wireless devices

Alarm Controllers	
Alarm Controllers	HS2016/HS2032/ HS2064/HS2128/ HS3032/HS3128/ HS3248
Modules	
Wireless keypads	HS2LCDWFx/ HS2LCDWFPx/ HS2LCDWFPVx
Wireless Devices	
PowerG wireless short range ceiling mount detector with temperature monitoring	PGx862 ^{UL}
PowerG wireless long range ceiling mount detector with temperature monitoring	PGx872 ^{UL}
PowerG wireless outdoor curtain PIR	PGx902 ^{UL}
PowerG wireless PRI motion detector with optional animal resistance	PGx904(P) ^{UL}
PowerG wireless PIR motion detector with temperature monitoring	PGx914(P) ^{UL}
PowerG wireless curtain PIR motion detector	PGx924 ^{UL}
PowerG wireless PIR motion detector with camera	PGx934(P) ^{UL}
PowerG wireless outdoor PIR motion detector with camera and with anti-masking	PGx944(P) ^{UL}
PowerG wireless mirror optic PIR motion detector	PGx974(P) ^{UL}
PowerG wireless dual technology (PIR and MW) with anti-masking	PGx984(P) ^{UL}
PowerG wireless outdoor PIR motion detector with anti-masking	PGx994
PowerG wireless recessed door/window contact	PGx307
PowerG wireless outdoor contact with auxiliary input, temperature monitoring, and anti-masking	PGx312 ^{UL}
PowerG wireless door/window contact with auxiliary input	PGx945 ^{UL}
PowerG wireless vanishing door/window contact	PGx975 ^{UL} / PGx303 ^{UL}
PowerG wireless glassbreak detector	PGx912 ^{UL} / PGx922 ^{UL}
PowerG wireless shock detector with auxiliary input	PGx935 ^{UL}
PowerG wireless flood detector	PGx985 ^{UL}

Table 2: Compatible wireless devices

PowerG wireless temperature detector	PGx905 ^{UL}
PowerG wireless temperature probe extender (requires PGx905)	PGTEMP-PROBE
PowerG wireless CO detector (US only)	PGx913 ^{UL}
PowerG wireless CO detector with temperature monitoring	PGx933 ^{UL}
PowerG wireless smoke and heat detector	PGx916 ^{UL}
PowerG wireless smoke and heat detector with temperature monitoring	PGx936 ^{UL}
PowerG wireless smoke detector	PGx926 ^{UL}
	PGx901 ^{UL}
PowerG wireless outdoor siren	PGx911 ^{UL}
PowerG wireless repeater	PGx920 ^{UL}
PowerG wireless 1-button security panic key	PGx938 ^{UL}
PowerG wireless 2-button security panic key	PGx949 ^{UL}
	PGx929 ^{UL}
	PGx939 ^{UL}
PowerG wireless 4-button security panic key	PGx929 ^{UL}
	PGx939 ^{UL}

① **Note:** Devices are not compatible in all markets.

Installing the HSM2HOST

This section describes how to install the HSM2HOST module.

Temporary mounting requirements

Before installing the HSM2HOST, you must temporarily mount the HSM2HOST in a location that meets the following requirements.

- Ensure that the location is dry.
- Ensure that the location is within the operating temperature range.
- Ensure that the location is central to the proposed placement of all wireless devices.
- Mount the module in a high location. Mounting the module below ground level can reduce the range of the system.
- Mount the module in a location that is far away from sources of interference, such as computers, electric motors, appliances, heating, air conditioning units, and other sources of electrical noise. Large metal objects like heating ducts and plumbing can also shield the electromagnetic waves
- Ensure that there are no obstructions blocking the rear of the unit.

Connecting the HSM2HOST to the alarm panel

About this task:

⚠ WARNING: Ensure that you disconnect all power supplies from the system before connecting the modules to the Corbus. Power supplies can include AC, DC, and telephone lines.

To connect the HSM2HOST to the alarm panel, complete the following steps:

1. Connect the HSM2HOST to the four-wire Corbus in the alarm panel. For more information, see Figure 1.
2. Turn on the system.

Figure 1: Wiring Diagram

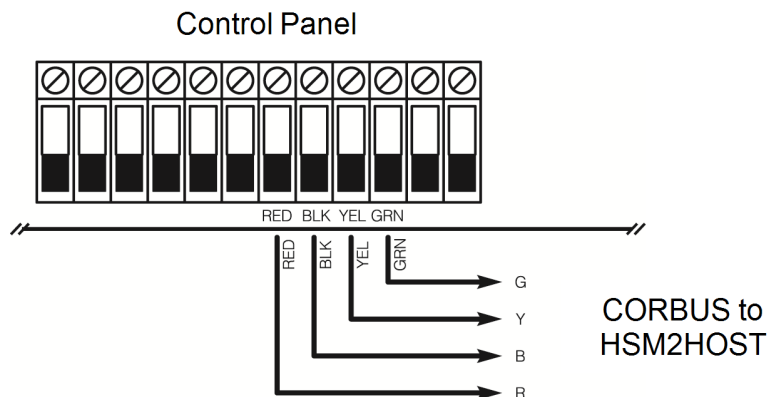

Enrolling The HSM2HOST

The enrollment of a HSM2HOST to an alarm panel is dependent on the system configuration.

Enrolling the HSM2HOST without a hardwired keypad

About this task:

To enroll the HSM2HOST without a hardwired keypad, complete the following steps:

1. Turn on the wireless keypad by connecting the power source.
 2. Simultaneously press [*] and [1] on the keypad.
- ⓘ **Note:** The system can take up to 30 seconds to complete the enrollment.

Enrolling the HSM2HOST with an enrolled hardwired keypad

About this task:

To enroll the HSM2HOST with an enrolled hardwired keypad, complete the following steps:

1. On the enrolled keypad, enter Installer Programming section [902][000] (Auto Enroll All Modules).
2. When the system prompts you, press [*].

Enrolling the HSM2HOST with only unenrolled hardwired keypads

About this task:

To enroll the HSM2HOST with only unenrolled hardwired keypad(s), complete the following steps:

1. Enroll only one hardwired keypad onto the system by pressing any key on the keypad.
2. Enter Installer Programming section [902][000](Auto Enroll All Modules).
3. When the system prompts you, press [*] to enroll the HSM2HOST and all other keypads or modules on the system.

Permanently mounting the HSM2HOST and wireless devices

About this task:

After a suitable location to permanently mount the HSM2HOST and wireless devices is found, complete the following steps:

1. Pull the Corbus wires through the holes at the back of the HSM2HOST cabinet.
2. Using a screwdriver, securely mount the HSM2HOST cabinet to the wall using the three screw supplied. For more information, see Figure 2.
3. To install the wall tamper, securely attach the breakaway wall tamper bracket to the wall using the screws supplied (ST#6 L1" PHIL FLAT ST ZN).
4. Install the wireless devices. For more information, refer to the device's Installation Guide.

Figure 2: Mounting the HSM2HOST

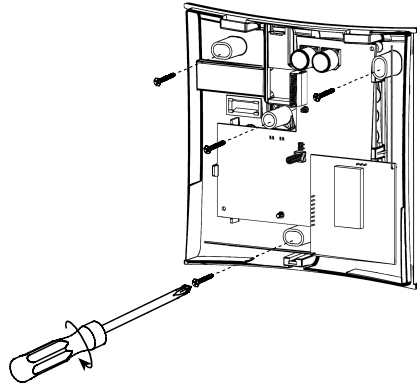

Other Options

The following actions can be performed on the HSM2HOST:

Section	Action
[902][106]	Delete the HSM2HOST from the alarm system.
[903][106]	Confirm that the HSM2HOST is enrolled.
[000][806]	Add a label to appear on LCD keypads.
[900][461]	View HSM2HOST model information.

Enrolling and programming wireless devices

This section describes how to enroll and program wireless devices such as contacts, motion sensors and sirens on the alarm panel.

[804][000] Enrolling wireless devices

About this task:

After the HSM2HOST is installed and enrolled on the alarm panel, wireless devices can be enrolled using the following method:

1. Enter Installer Programming section [804][000].
2. When prompted, either activate the device (see device installation sheet) to enroll immediately or enter a device ID number. Do the latter to pre-enroll devices then enroll them later at the customer site. The alarm panel determines the type of device being enrolled and presents the appropriate programming options.

Table 3: Wireless Device Options

Device Type	Programming Options
Zone	(01) Zone type (02) Partition assignment (03) Zone label
Wireless Key	(01) Partition assignment (02) User label
Siren	(01) Partition assignment (02) Siren label
Repeater	(01) Repeater label

3. Use the scroll keys or type in the corresponding number to select an option.
 4. Scroll through the available selections, key in a number or enter text as appropriate.
 5. Press [*] to accept and move to the next option.
 6. After all options are configured, the system prompts you to enroll the next device.
 7. Repeat the above steps until all wireless devices are enrolled.
- ⓘ **Note:** The configuration options listed above can be modified using [804][911] Modify Device.

[804][001]-[716] Wireless Device Configuration

To configure wireless devices, complete the following steps:

1. Enter Installer Programming section [804] then select one of the following sub-sections:
 - 001-248 – Configure Wireless Zones
 - 601-632 – Configure Wireless Keys
 - 701-716 – Configure Wireless Keypads
2. Select a device to configure using the scroll keys or go directly to a specific device by entering a hotkey.

3. Use the scroll buttons or enter a hotkey to select a configuration option for the device. See wireless device installation sheets for details.
 4. Press [*] to accept and move to the next option.
 5. After all options are configured, the system returns to the base configuration menu.
 6. Repeat the above steps to configure other wireless devices.
- ⓘ **Note:** The configuration options listed above can be modified using [804][911] Modify Device.

[804][801] RF Jam Detect

About this task:

RF jam detection (continuous interfering transmissions on the radio network) can be turned on or off. When on, RF jamming is logged and reported.

To configure RF jamming, complete the following steps:

1. Enter Installer Programming section [804][801] then select one of the following options:

00	Disabled	Jamming detection and reporting is enabled/disabled. ⓘ Note: Must be enabled for UL/ULC listed installations.
01	UL 20/20-USA	Continuous RF jamming for 20 seconds
02	EN 30/60-Europe	30 seconds of accumulated jamming within 60 seconds
03	Class 6 30/60-British	As EN (30/60) but reported only if the jamming duration exceeds 5 minutes

2. Press [*] to accept the selection.
3. Press [#] to exit the section.

[804][802] Wireless supervisory time window

About this task:

This option is used to program the length of time a wireless device can be absent from the system before a fault is generated.

Before programming the wireless supervisory time window, note the following UL/ULC specifications:

Table 4: UL/ULC wireless supervision specifications

UL/ULC specifications	Maximum wireless supervision time window
UL Residential Burglary (UL1023)	24 hours
Home Health Care (UL1637)	24 hours
ULC Residential Burglary (ULC/ORD-C1023)	24 hours
UL Residential Fire (UL985) installations	200 seconds
UL Commercial Burglary (UL1610/UL365)	4 hours
ULC Residential Fire (ULC-S545)	4 hours

To program the wireless supervisory time window, complete the following steps:

1. Enter Installer Programming section [804][802].
2. Select one of the following options by scrolling or entering the hot key:
 - 00 – Disabled

- 01 – After 1 Hour
- 02 – After 2 Hours
- 03 – After 4 Hours
- 04 – After 8 Hours
- 05 – After 12 Hours
- 06 – After 24 Hours

3. Press [*] to accept the selection.
4. Press [#] to exit the section.

Result:

For EN installations, 1 hour or 2 hours must be selected.

When option 06 is used, which configures the system to generate fault conditions after a device has been detected as absent for 24 hours, smoke detectors generate a fault condition after a maximum of 18 hours when the 200s supervision toggle option is disabled.

[804][810] Wireless Option 1

About this task:

To program wireless options, complete the following steps:

1. Enter Installer Programming section [804][810].
2. Select one of the following options by scrolling or entering the hotkey:

01	RF Delinquency	On: the system cannot be armed if a wireless supervisory trouble exists. An RF delinquency trouble is generated. Off: wireless supervisory troubles do not prevent arming.
02	Wireless Supervisory/ RF Jam Alarm	On: if a supervisory or jamming trouble occurs during Away arming, the siren activates and the event is logged and reported. Off: supervisory or RF jam troubles during Away arming do not activate the siren or get logged and reported.
03	Wireless Tamper	On: module tampers are logged and reported. Off: module tampers are not logged or reported.
04	Fire Supervision	On: fire devices are supervised every 200 seconds. If the device fails to report within this window, a supervision trouble is generated. Off: fire devices follow the supervision window programmed in section 802, up to a maximum of 18 hours. The supervisory window can be programmed with a higher value, but detectors still go into fault after 18 hours.
05	Smart Temperature Reporting	On: Wireless devices with smart temperature reporting support will periodically report their ambient temperature to the control panel. Off: Smart temperature reporting is disabled on all devices.

3. Press [*] to accept the selection and [#] to exit.

[804][841] Motion cameras

About this task:

To program motion cameras, complete the following steps:

1. Enter Installer Programming section [804][841].
2. Select one of the following options by scrolling or entering the hotkey:

[001]	Visual Verification	On: Alarms trigger image capture from PIR Cameras Off: Alarms do not trigger image capture from PIR Cameras
[002]	View Time Window	01 Alarm + 5 Minutes 02 Alarm + 15 minutes 03 Alarm + 1 Hour Note: The Video on Demand via Integration sessions follow this configuration.
[003]	View Other Alarms	01 Fire key enabled/disabled 02 Duress enabled/disabled 03 Medical key enabled/disabled 04 Panic key enabled/disabled Note: Video on Demand by third-party integrators follow this configuration.

A maximum of 8 zones can be assigned to a PIR camera to initiate video capture. When an alarm occurs on any of the 8 zones, the panel initiates video capture from the PIR camera.

- Note:** This option is only available with a PIR camera, for example the PGx934 or PGx944.

[804][901]-[905] Deleting wireless devices

About this task:

To delete wireless devices, complete the following steps:

1. Enter Installer Programming section [804] then select one of the following sub-sections:
 - [901] – Delete wireless zone devices
 - [902] – Delete wireless key
 - [904] – Delete repeaters
 - [905] – Delete keypads
2. Scroll or enter a hotkey to select a device.
3. Press [*] to delete or [#] to exit.

[804][921]-[925] Replacing wireless devices

About this task:

Use this option to replace a faulty device enrolled on the system with another device of the same type while maintaining the configuration of the original. The faulty device does not need to be deleted.

To replace a wireless device, complete the following steps:

1. Enter Installer Programming section [804] then select one of the following sub-sections:
 - [921] – Replace wireless zone devices
 - [922] – Replace wireless key
 - [924] – Replace repeaters
 - [925] – Replace keypads
2. Press [*] to select a sub-section. The first available device is displayed.
3. Scroll or enter a hotkey to select a device, press [*].
4. When prompted, activate the device (full enrollment) or enter the device ID (pre-enrollment). A message is displayed confirming enrollment.

[804][990][001 – 005] Show all devices

About this task:

Use this section to review wireless devices enrolled on the system and to view serial numbers associated with each device.

To review wireless device information, complete the following steps:

1. Enter Installer Programming section [804][990] then select one of the following sub-sections:
 - [001] – All zones
 - [002] – Repeaters
 - [004] – Wireless keys
 - [005] – keypads
2. Press [*] to select a wireless device type. The first available device is displayed.
3. Use the scroll keys to view the enrolled devices.
 - ⓘ **Note:** This option is not fully supported by LED and ICON keypads.

[804][999] Reset to factory defaults

Selecting this option resets HSM2HOST programming to factory default settings.

[904] Placement testing of wireless devices

This test is used to determine RF signal status for wireless devices and can be performed at a system keypad or at the individual device. These instructions pertain to testing at the keypad. For instructions on placement testing at the device, refer to the installation sheet provided with the wireless equipment. The following test modes are available:

[904][001]-[128]	Test wireless zones	Test wireless devices individually by zone. Zones with vanishing contacts must be activated to placement test.
[904][521]-[528]	Test all repeaters	Test each enrolled wireless repeater. 521-528 for repeaters 1-8
[904][551]-[566]	Test all sirens	Test each enrolled wireless siren. 551-566 for sirens 1-16
[904][601]-[632]	Test all wireless keys	Test individual wireless keys. Once in this section, press a button on the wireless key to begin the test. 601-632 for wireless keys 1-32.
[904][701]-[716]	Test all keypads	Test each enrolled keypad. 701-716 for keypads 1-16

Two test results are provided:

- 24-hour: Average results of signal strength testing over a 24-hour period.
- Now: Signal status results of the current test.

A flashing Trouble LED indicates RF interference. The following status indicators may be displayed:

LCD	Icon*	LED+	Status
Strong	1	9	Strong signal strength
Good	2	10	Good signal strength
Poor	3	11	Poor signal strength
Not Test	5	13	Displayed as the Now result if no test was performed
Not Test	5	13	Always displayed as the 24-hour result when testing wireless keys

*For Icon keypads, digit 1 indicates 24-hour test results; digit 2 indicates Now test results.

+For LED keypads, the first digit indicates 24-hour results; the second digit indicates Now test results.

ⓘ **Note:** For EN/UL/ULC installations, only strong signal levels are acceptable.

Programming Worksheets

Use these pages to record custom programming options (Installers Programming: [*][8]).

[902]	Enroll Module	000 - Auto Enroll
		001 - Enroll Modules
		002 - Module Slot Assignment (LED/ICON)
		003 - Module Slot Assignment (LED only)
	Delete Module	101 - Delete Keypads
		102 - Delete Zone Expander
		103 - Delete Output Expander
		106 - Delete HSM2HOST
		108 - Delete Audio Verification
109 - Delete Power Supply		
[903]	Confirm Module	001 - Confirm Keypad
		002 - Confirm Zone Expander
		003 - Confirm Output Expander
		006 - Confirm HSM2HOST
		008 - Confirm Audio Verification
		009 - Confirm Power Supply

[804] Wireless programming

[000]	Enroll Wireless Device
	Zone
	Wireless Key
	Siren
	Keypad
	Repeater

[804][000] Wireless device enrollment – Wireless keys

Key#	Partition #	User	Label	Key#	Partition #	User	Label
1				17			
2				18			
3				19			
4				20			
5				21			
6				22			
7				23			
8				24			
9				25			
10				26			
11				27			
12				28			
13				29			
14				30			
15				31			
16				32			

[804][000] Wireless device enrollment – Wireless keypads

WLS Keypad #	Keypad Assignment	Keypad Label	WLS Keypad #	Keypad Assignment	Keypad Label
1			9		
2			10		
3			11		
4			12		
5			13		
6			14		
7			15		
8			16		

[804][000] Wireless device enrollment – Wireless repeaters

Repeater #	Repeater Label
1	
2	
3	
4	
5	
6	
7	
8	

[804][001]-[128] Configure wireless zones 1-128

Zone#:			
Toggle Options			
	[001] Device Options		[003] High Traffic Shutdown
x	01 – Alarm LED	x	01 – Not Active
x	02 – Reed Switch		02 – Yes - No Delay
	03 – External Input On		03 – Yes - 5s Delay
x	04 – Supervision		04 – Yes - 15s Delay
	05 – Not Used		05 – Yes - 30s Delay
	06 – Not Used		06 – Yes - 1m Delay
	07 – Anti- Masking		07 – Yes - 5m Delay
	08 – Not Used		08 – Yes - 10m Delay
	09 – Shock Accumulator		09 – Yes - 20m Delay
	10 – Not Used		10 – Yes - 60m Delay
x	11 – 24hr/Night		[004] Image Brightness
	12 – Not used		01 – Image Bright -3
	13 – Not Used		02 – Image Bright -2
x	14 – Fire Alarm		03 – Image Bright -1
	15 – Not Used	x	04 – Image Bright 0
	16 – Not Used		05 – Image Bright +1
	[002] Zone EOL		06 – Image Bright +2
	00 – Disable		07 – Image Bright +3
x	01 – Single EOL		

Zone#:		
Toggle Options		
	02 – Normally Open	
	03 – Normally Closed	
	04 – Double EOL	
Zone#:		
Toggle Options		
	[005] Image Contrast	[011] - Camera Toggles
	01 – Image Contrast -3	01- Color
	02 – Image Contrast -2	02 - High Resolution
	03 – Image Contrast -1	03 - Low Quality
	04 – Image Contrast - 0	04 - Microphone
	05 – Image Contrast +1	05 - Video on Demand
	06 – Image Contrast +2	06 - Video on Demand (away only) override <i>i</i> Note: This overrides [851][010] Option 5 Video on Demand in away mode only, when enabled.
	07 – Image Contrast +3	[016] Event Counter
		001-002 (Default: 002)
	[006] Detection Range	[018] Shock Sensitivity
	01 - Low Sensitivity	001-019 (Default: 008)
	02- Mid Sensitivity	[019] High Temperature Warning
	03 - High Sensitivity	+/- 000 to 999
	[007] Detection Security	[020] High Temperature Alarm
	01 - Low Sensitivity	+/- 000 to 999
	02 - High Sensitivity	+/- 000 to 999
	03-UL Standard	[022] Low Temperature Alarm
		+/- 000-999c (Default: 999c)
	[010] Anti-masking	[025]-[032] Camera Zone Assignment
	01- Disabled	
	02- Low Sensitivity	
	03- High Sensitiity	

[804][551]-[566] Configure wireless sirens 1-16 (copy as needed)

Zone#				
Toggle Options				
	[000] Partition Assignment		1 2 3 4 5 6 7 8	
	[001] Device Toggles		[002] Strobe Alarm	[004] Squawk
x	01 - Fire Alarm		01 - Disabled	01 - Disabled
x	02 - Gas/CO Alarm	x	02 - Timer Limited	x 02 - Sounder Only
x	03 - Burglary Alarm		03 - Until Disarmed	03 - Strobe Only
x	04 - Flood Alarm		[003] Exit Entry Beeps	04 - Sounder/Strobe
	05 - Not Used	x	01 - Disabled	[005] Sounder Volume
	06 - Auto Temp Alarm		02 - Enabled	01 - Low
	07 - Activity LED		03 - Disabled Stay	x 02 - Medium
	08 - Not Used			03 - High
	09 - AC Power			
x	10 - Buzzer Notification			
x	11 - Door Chime			
x	12 - Trouble Beep			

Zone#				
Toggle Options				
	[000] Partition Assignment		1 2 3 4 5 6 7 8	
	[001] Device Toggles		[002] Strobe Alarm	[004] Squawk
x	01 - Fire Alarm		01 - Disabled	01 - Disabled
x	02 - Gas/CO Alarm	x	02 - Timer Limited	x 02 - Sounder Only
x	03 - Burglary Alarm		03 - Until Disarmed	03 - Strobe Only
x	04 - Flood Alarm		[003] Exit Entry Beeps	04 - Sounder/Strobe
	05 - Not Used	x	01 - Disabled	[005] Sounder Volume
	06 - Auto Temp Alarm		02 - Enabled	01 - Low
	07 - Activity LED		03 - Disabled Stay	x 02 - Medium
	08 - Not Used			03 - High
	09 - AC Power			
x	10 - Buzzer Notification			
x	11 - Door Chime			
x	12 - Trouble Beep			

[804][601]-[632] Configure Wireless Keys (copy as needed)

[000] Wireless Key Partition Assignment (Default: 01)

[001]-[005] Wireless Key Button Programming (Defaults: Key 1: 04, Key 2: 03, Key 3: 01, Key 4: 52, Key 5: 21)

[011] Wireless Key Device Toggles (Default: 01)

[020] Wireless Key User Assignment (Default: 00 – Not Assigned)

Available programming options:			
00- Disabled (Null)	06- Chime On/Off	15- Temperature	24- Comm. Output 4
01- Disarm	07- System Test	16- Quick Exit	29- Bypass Group Recall
02- Instant Stay Arm	09- Night Arm	17- Arm Interior	33- Bypass Recall
03- Stay Arm	12- Global Stay Arm	21- Comm. Output 1	51- [M] Key Alarm
04- Away Arm	13- Global Away Arm	22- Comm. Output 2	52- [P] Key Alarm
05- [*][9] No Entry	14- Global Disarm	23- Comm. Output 3	

[601]-[632] Wireless Key 1-32

Wireless Key#	Partition	Button	Supervision	Yes	No	User Number
	1 2 3 4 5 6 7 8	1: 2: 3: 4: 5			x	
Wireless Key#	Partition	Button	Supervision	Yes	No	User Number
	1 2 3 4 5 6 7 8	1: 2: 3: 4: 5			x	
Wireless Key#	Partition	Button	Supervision	Yes	No	User Number
	1 2 3 4 5 6 7 8	1: 2: 3: 4: 5			x	

Wireless Key#	Partition	Button	Supervision	Yes	No	User Number
	1 2 3 4 5 6 7 8	1: 2: 3: 4: 5			x	
Wireless Key#	Partition	Button	Supervision	Yes	No	User Number
	1 2 3 4 5 6 7 8	1: 2: 3: 4: 5			x	

[804]-[701]-[716] Wireless Keypad Programming

Keypad #						
[000]	Partition Assignment		00 - Global		03 - Partition 3	03 - Partition 3
		x	01 - Partition 1		04 - Partition 4	04 - Partition 4
			02 - Partition 2		05 - Partition 5	05 - Partition 5

Function Key Programming Options			
00 - Null Key		30 - Quick Bypass	
02 - Instant Stay Arm	13 - Global Away Arm	31 - Local PGM Active	
03 - Stay Arm	14 - Global Disarming	32 - Bypass Mode	61 - Partition Select 1
04 - Away Arm	15 - Temperature	33 - Bypass Recall	62 - Partition Select 2
05 - [*][9]No Entry Arm	16 - Quick Exit	34 - User Programming	63 - Partition Select 3
06 - Chime On/Off	17 - Arm Interior	35 - User Functions	64 - Partition Select 4
07 - System Test	21 - Command Output 1	36 - Reactivate Stay/Away/Night zones	65 - Partition Select 5
09 - Night Arm	22 - Command Output 2	37 - Time/Date Programming	66 - Partition Select 6
11 - Away Arm no Entry	23 - Command Output 3	39 - Trouble Display	67 - Partition Select 7
12 - Global Stay Arm	24 - Command Output 4	40 - Alarm Memory	68 - Partition Select 8
	29 - Bypass Group Recall		
Function Key:	[001] - Key 1: (Default: 03)	[003] - Key 3: (Default: 06)	[005] - Key 5: (Default: 16)
	[002] - Key 2: (Default: 04)	[004] - Key 4: (Default: 22)	
[011] Keypad I/O (Zone number or output number; 3-digit decimal; Default: 000)			
[012] Local PGM Output Timer:		Pulse Time (Default:00 minutes):	
		Pulse Time (Default:05 minutes):	

[021] Keypad Option 1	x	01 - [F] Key Enabled
	x	02 - [M] Key Enabled
	x	03 - [P] Key Enabled
	x	04 - Display Code or X's
[022] Keypad Option 1	x	01 - Local Clock Display
		02 - Local Clock 24-Hour
	x	03 - Auto Alarm Scroll
	x	05 - Power LED
	x	06 - Power LED AC Present
	x	07 - Alarms Displayed if Armed
	x	08 - Auto Scroll Open Zones

[023] Keypad Option 3		01 – Armed LED Power Save
	x	02 – Keypad Status Shows Arm Mode
		03 – 5th Terminal is PGM Output/Zone Input
		07 – Local Display of Temperature
		08 – Low Temperature Warning

[030] LCD Message:
[031] Downloaded LCD Message Duration (3-digit decimal; 000-255; Default: 000):
[041] Indoor Temperature Zone Entry (3-digit decimal; 000-128; Default: 000):
[042] Outdoor Temperature Zone Entry (3-digit decimal; 000-128; Default: 000):

[101]-[128] Door Chime Beeps:		00 – Disabled
	x	01 – 6 beeps
		02 – Bing Bong
		03 – Ding Dong
		04 – Alarm Tone
		05 – Zone Name

Door Chime Zone Assignment:									
1 ___	2 ___	3 ___	4 ___	5 ___	6 ___	7 ___	8 ___	9 ___	10 ___
11 ___	12 ___	13 ___	14 ___	15 ___	16 ___	17 ___	18 ___	19 ___	20 ___
21 ___	22 ___	23 ___	24 ___	25 ___	26 ___	27 ___	28 ___	29 ___	30 ___
31 ___	32 ___	33 ___	34 ___	35 ___	36 ___	37 ___	38 ___	39 ___	40 ___
41 ___	42 ___	43 ___	44 ___	45 ___	46 ___	47 ___	48 ___	49 ___	50 ___
51 ___	52 ___	53 ___	54 ___	55 ___	56 ___	57 ___	58 ___	59 ___	60 ___
61 ___	62 ___	63 ___	64 ___	65 ___	66 ___	67 ___	68 ___	69 ___	70 ___
71 ___	72 ___	73 ___	74 ___	75 ___	76 ___	77 ___	78 ___	79 ___	80 ___
81 ___	82 ___	83 ___	84 ___	85 ___	86 ___	87 ___	88 ___	89 ___	90 ___
91 ___	92 ___	93 ___	94 ___	95 ___	96 ___	97 ___	98 ___	99 ___	100 ___
101 ___	102 ___	103 ___	104 ___	105 ___	106 ___	107 ___	108 ___	109 ___	110 ___
111 ___	112 ___	113 ___	114 ___	115 ___	116 ___	117 ___	118 ___	119 ___	120 ___
121 ___	122 ___	123 ___	124 ___	125 ___	126 ___	127 ___	128 ___		

[804][801] Jam Detect			[804][802] Supervisory Window			[804][810] Wireless Options		
UL	EN		UL	EN	Disabled	UL	EN	
		Disabled			After 1 Hour			1 – RF Delinquency Tamper

x		UL - UL 20/20			x	After 2 Hours			x	2 - Missing/Jam Alarm
	x	EN 30/60				After 4 Hours				3 - Wireless Tamper
		Class 6 (30/60)				After 8 Hours				4 - 200s Fire Supervision
						After 12 Hours				5- Smart Temperature Reporting
				x		After 24 Hours				

[804][841] Motion Cameras

001 Visual Verification		01 - Disabled
	x	02 - Enabled
002 View Time Window		03 - Enabled
	x	01 - Alarm + 5 Minutes
		02 - Alarm + 15 Minutes
003 View Other Alarms		03 - Alarm + 1 Hour
	x	01 - Fire Alarm
	x	02 - Duress Alarm
	x	03 - Medical Alarm
	x	04 - Panic Alarm

[804][901]-[905] Delete Wireless Devices

[901]	Delete Zones
[902]	Delete Wireless Keys
[903]	Delete Sirens
[904]	Delete Repeaters
[905]	Delete Keypads

[804][921]-[925] Replace Wireless Devices

[921]	Replace Zones
[922]	Replace Wireless Keys
[923]	Replace Sirens
[924]	Replace Repeaters
[925]	Replace Keypads

[804][990] Show All Devices

[001]	Show All Zones
[002]	Show All Repeaters
[003]	Sirens
[004]	Wireless Keys
[005]	Keypads

LIMITED WARRANTY

LIMITED WARRANTY

Digital Security Controls warrants the original purchaser that for a period of twelve months from the date of purchase, the product shall be free of defects in materials and workmanship under normal use. During the warranty period, Digital Security Controls shall, at its option, repair or replace any defective product upon return of the product to its factory, at no charge for labour and materials. Any replacement and/or repaired parts are warranted for the remainder of the original warranty or ninety (90) days, whichever is longer. The original purchaser must promptly notify Digital Security Controls in writing that there is defect in material or workmanship, such written notice to be received in all events prior to expiration of the warranty period. There is absolutely no warranty on software and all software products are sold as a user license under the terms of the software license agreement included with the product. The Customer assumes all responsibility for the proper selection, installation, operation and maintenance of any products purchased from DSC. Custom products are only warranted to the extent that they do not function upon delivery. In such cases, DSC can replace or credit at its option.

International Warranty

The warranty for international customers is the same as for any customer within Canada and the United States, with the exception that Digital Security Controls shall not be responsible for any customs fees, taxes, or VAT that may be due.

Warranty Procedure

To obtain service under this warranty, please return the item(s) in question to the point of purchase. All authorized distributors and dealers have a warranty program. Anyone returning goods to Digital Security Controls must first obtain an authorization number. Digital Security Controls will not accept any shipment whatsoever for which prior authorization has not been obtained.

Conditions to Void Warranty

This warranty applies only to defects in parts and workmanship relating to normal use. It does not cover:

- damage incurred in shipping or handling
- damage caused by disaster such as fire, flood, wind, earthquake or lightning;
- damage due to causes beyond the control of Digital Security Controls such as excessive voltage, mechanical shock, water damage;
- damage caused by unauthorized attachment, alterations, modifications or foreign objects;
- damage caused by peripherals (unless such peripherals were supplied by Digital Security Controls Ltd.);
- defects caused by failure to provide a suitable installation environment for the products;
- damage caused by use of the products for purposes other than those for which it was designed;
- damage from improper maintenance;
- damage arising out of any other abuse, mishandling or improper application of the products.

Items Not Covered by Warranty

In addition to the items which void the Warranty, the following items shall not be covered by Warranty: (i) freight cost to the repair centre; (ii) products which are not identified with DSC's product label and lot number or serial number; (iii) products disassembled or repaired in such a manner as to adversely affect performance or prevent adequate inspection or testing to verify any

warranty claim. Access cards or tags returned for replacement under warranty will be credited or replaced at DSC's option. Products not covered by this warranty, or otherwise out of warranty due to age, misuse, or damage shall be evaluated, and a repair estimate shall be provided. No repair work will be performed until a valid purchase order is received from the Customer and a Return Merchandise Authorization number (RMA) is issued by DSC's Customer Service.

Digital Security Controls Ltd.'s liability for failure to repair the product under this warranty after a reasonable number of attempts will be limited to a replacement of the product, as the exclusive remedy for breach of warranty. Under no circumstances shall Digital Security Controls be liable for any special, incidental, or consequential damages based upon breach of warranty, breach of contract, negligence, strict liability, or any other legal theory. Such damages include, but are not limited to, loss of profits, loss of the product or any associated equipment, cost of capital, cost of substitute or replacement equipment, facilities or services, down time, purchaser's time, the claims of third parties, including customers, and injury to property. The laws of some jurisdictions limit or do not allow the disclaimer of consequential damages. If the laws of such a jurisdiction apply to any claim by or against DSC, the limitations and disclaimers contained here shall be to the greatest extent permitted by law. Some states do not allow the exclusion or limitation of incidental or consequential damages, so that the above may not apply to you.

Disclaimer of Warranties

This warranty contains the entire warranty and shall be in lieu of any and all other warranties, whether expressed or implied (including all implied warranties of merchantability or fitness for a particular purpose) and of all other obligations or liabilities on the part of Digital Security Controls. Digital Security Controls neither assumes responsibility for, nor authorizes any other person purporting to act on its behalf to modify or to change this warranty, nor to assume for it any other warranty or liability concerning this product. This disclaimer of warranties and limited warranty are governed by the laws of the province of Ontario, Canada.

WARNING: Digital Security Controls recommends that the entire system be completely tested on a regular basis. However, despite frequent testing, and due to, but not limited to, criminal tampering or electrical disruption, it is possible for this product to fail to perform as expected.

Out of Warranty Repairs

Digital Security Controls will at its option repair or replace out-of-warranty products which are returned to its factory according to the following conditions. Anyone returning goods to Digital Security Controls must first obtain an authorization number. Digital Security Controls will not accept any shipment whatsoever for which prior authorization has not been obtained.

Products which Digital Security Controls determines to be repairable will be repaired and returned. A set fee which Digital Security Controls has predetermined and which may be revised from time to time, will be charged for each unit repaired.

Products which Digital Security Controls determines not to be repairable will be replaced by the nearest equivalent product available at that time. The current market price of the replacement product will be charged for each replacement unit.

WARNING – READ CAREFULLY

Note to Installers

This warning contains vital information. As the only individual in contact with system users, it is your responsibility to bring each item in this warning to the attention of the users of this system.

System Failures

This system has been carefully designed to be as effective as possible. There are circumstances, however, involving fire, burglary, or other types of emergencies where it may not provide protection. Any alarm system of any type may be compromised deliberately or may fail to operate as expected for a variety of reasons. Some but not all of these reasons may be:

Inadequate Installation

A security system must be installed properly in order to provide adequate protection. Every installation should be evaluated by a security professional to ensure that all access points and areas are covered. Locks and latches on windows and doors must be secure and operate as intended. Windows, doors, walls, ceilings and other building materials must be of sufficient strength and construction to provide the level of protection expected. A reevaluation must be done during and after any construction activity. An evaluation by the fire and/or police department is highly recommended if this service is available.

Criminal Knowledge

This system contains security features which were known to be effective at the time of manufacture. It is possible for persons with criminal intent to develop techniques which reduce the effectiveness of these features. It is important that a security system be reviewed periodically to ensure that its features remain effective and that it be updated or replaced if it is found that it does not provide the protection expected.

Access by Intruders

Intruders may enter through an unprotected access point, circumvent a sensing device, evade detection by moving through an area of insufficient coverage, disconnect a warning device, or interfere with or prevent the proper operation of the system.

Power Failure

Control units, intrusion detectors, smoke detectors and many other security devices require an adequate power supply for proper operation. If a device operates from batteries, it is possible for the batteries to fail. Even if the batteries have not failed, they must be charged, in good condition and installed correctly. If a device operates only by AC power, any interruption, however brief, will render that device inoperative while it does not have power. Power interruptions of any length are often accompanied by voltage fluctuations which may damage electronic equipment such as a security system. After a power interruption has occurred, immediately conduct a complete system test to ensure that the system operates as intended.

Failure of Replaceable Batteries

This system's wireless transmitters have been designed to provide several years of battery life under normal conditions. The expected battery life is a function of the device environment, usage and type. Ambient conditions such as high humidity, high or low temperatures, or large temperature fluctuations may reduce the expected battery life. While each transmitting device has a low battery monitor which identifies when the batteries need to be replaced, this monitor may fail to operate as expected. Regular testing and maintenance will keep the system in good operating condition.

Compromise of Radio Frequency (Wireless) Devices

Signals may not reach the receiver under all circumstances which could include metal objects placed on or near the radio path or deliberate jamming or other inadvertent radio signal interference.

System Users

A user may not be able to operate a panic or emergency switch possibly due to permanent or temporary physical disability, inability to reach the device in time, or unfamiliarity with the correct operation. It is important that all system users be trained in the correct operation of the alarm system and that they know how to respond when the system indicates an alarm.

Smoke Detectors

Smoke detectors that are a part of this system may not properly alert occupants of a fire for a number of reasons, some of which follow. The smoke detectors may have been improperly installed or positioned. Smoke may not be able to reach the smoke detectors, such as when the fire is in a chimney, walls or roofs, or on the other side of closed doors. Smoke detectors may not detect smoke from fires on another level of the residence or building.

Every fire is different in the amount of smoke produced and the rate of burning. Smoke detectors cannot sense all types of fires equally well. Smoke detectors may not provide timely warning of fires caused by carelessness or safety hazards such as smoking in bed, violent explosions, escaping gas, improper storage of flammable materials, overloaded electrical circuits, children playing with matches or arson.

Even if the smoke detector operates as intended, there may be circumstances when there is insufficient warning to allow all occupants to escape in time to avoid injury or death.

Motion Detectors

Motion detectors can only detect motion within the designated areas as shown in their respective installation instructions. They cannot discriminate between intruders and intended occupants. Motion detectors do not provide volumetric area protection. They have multiple beams of detection and motion can only be detected in unobstructed areas covered by these beams. They cannot detect motion which occurs behind walls, ceilings, floor, closed doors, glass partitions, glass doors or windows. Any type of tampering whether intentional or unintentional such as masking, painting, or spraying of any material on the lenses, mirrors, windows or any other part of the detection system will impair its proper operation.

Passive infrared motion detectors operate by sensing changes in temperature. However their effectiveness can be reduced when the ambient temperature rises near or above body temperature or if there are intentional or unintentional sources of heat in or near the detection area. Some of these heat sources could be heaters, radiators, stoves, barbeques, fireplaces, sunlight, steam vents, lighting and so on.

Warning Devices

Warning devices such as sirens, bells, horns, or strobes may not warn people or waken someone sleeping if there is an intervening wall or door. If warning devices are located on a different level of the residence or premise, then it is less likely that the occupants will be alerted or awakened. Audible warning devices may be interfered with by other noise sources such as stereos, radios, televisions, air conditioners or other appliances, or passing traffic. Audible warning devices, however loud, may not be heard by a hearing-impaired person.

Telephone Lines

If telephone lines are used to transmit alarms, they may be out of service or busy for certain periods of time. Also an intruder may cut the telephone line or defeat its operation by more sophisticated means which may be difficult to detect.

Insufficient Time

There may be circumstances when the system will operate as intended, yet the occupants will not be protected from the emergency due to their inability to respond to the warnings in a timely manner. If the system is monitored, the response may not occur in time to protect the occupants or their belongings.

Component Failure

Although every effort has been made to make this system as reliable as possible, the system may fail to function as intended due to the failure of a component.

Inadequate Testing

Most problems that would prevent an alarm system from operating as intended can be found by regular testing and maintenance. The complete system should be tested weekly and immediately after a break-in, an attempted break-in, a fire, a storm, an earthquake, an accident, or any kind of construction activity inside or outside the premises. The testing should include all sensing devices, keypads, consoles, alarm indicating devices and any other operational devices that are part of the system.

Security and Insurance

Regardless of its capabilities, an alarm system is not a substitute for property or life insurance. An alarm system also is not a substitute for property owners, renters, or other occupants to act prudently to prevent or minimize the harmful effects of an emergency situation.

IMPORTANT - READ CAREFULLY: DSC Software purchased with or without Products and Components is copyrighted and is purchased under the following license terms:

- This End-User License Agreement (“EULA”) is a legal agreement between You (the company, individual or entity who acquired the Software and any related Hardware) and Digital Security Controls, a division of Tyco Safety Products Canada Ltd. (“DSC”), the manufacturer of the integrated security systems and the developer of the software and any related products or components (“HARDWARE”) which You acquired.
- If the DSC software product (“SOFTWARE PRODUCT” or “SOFTWARE”) is intended to be accompanied by HARDWARE, and is NOT accompanied by new HARDWARE, You may not use, copy or install the SOFTWARE PRODUCT. The SOFTWARE PRODUCT includes computer software, and may include associated media, printed materials, and “online” or electronic documentation.
- Any software provided along with the SOFTWARE PRODUCT that is associated with a separate end-user license agreement is licensed to You under the terms of that license agreement.
- By installing, copying, downloading, storing, accessing or otherwise using the SOFTWARE PRODUCT, You agree unconditionally to be bound by the terms of this EULA, even if this EULA is deemed to be a modification of any previous arrangement or contract. If You do not agree to the terms of this EULA, DSC is unwilling to license the SOFTWARE PRODUCT to You, and You have no right to use it.

SOFTWARE PRODUCT LICENSE

The SOFTWARE PRODUCT is protected by copyright laws and international copyright treaties, as well as other intellectual property laws and treaties. The SOFTWARE PRODUCT is licensed, not sold.

1. GRANT OF LICENSE This EULA grants You the following rights:

(a) Software Installation and Use - For each license You acquire, You may have only one copy of the SOFTWARE PRODUCT installed.

(b) Storage/Network Use - The SOFTWARE PRODUCT may not be installed, accessed, displayed, run, shared or used concurrently on or from different computers, including a workstation, terminal or other digital electronic device (“Device”). In other words, if You have several workstations, You will have to acquire a license for each workstation where the SOFTWARE will be used.

(c) Backup Copy - You may make back-up copies of the SOFTWARE PRODUCT, but You may only have one copy per license installed at any given time. You may use the back-up copy solely for archival purposes. Except as expressly provided in this EULA, You may not otherwise make copies of the SOFTWARE PRODUCT, including the printed materials accompanying the SOFTWARE.

2. DESCRIPTION OF OTHER RIGHTS AND LIMITATIONS

(a) Limitations on Reverse Engineering, Decompilation and Disassembly - You may not reverse engineer, decompile, or disassemble the SOFTWARE PRODUCT, except and only to the extent that such activity is expressly permitted by applicable law notwithstanding this limitation. You may not make any changes or modifications to the Software, without the written permission of an officer of DSC. You may not remove any proprietary notices, marks or labels from the Software Product. You shall institute reasonable measures to ensure compliance with the terms and conditions of this EULA.

(b) Separation of Components - The SOFTWARE PRODUCT is licensed as a single product. Its component parts may not be separated for use on more than one HARDWARE unit.

(c) Single INTEGRATED PRODUCT - If You acquired this SOFTWARE with HARDWARE, then the SOFTWARE PRODUCT is licensed with the HARDWARE as a single integrated product. In this case, the SOFTWARE PRODUCT may only be used with the HARDWARE as set forth in this EULA.

(d) Rental - You may not rent, lease or lend the SOFTWARE PRODUCT. You may not make it available to others or post it on a server or web site.

(e) Software Product Transfer - You may transfer all of Your rights under this EULA only as part of a permanent sale or transfer of the HARDWARE, provided You retain no copies, You transfer all of the SOFTWARE PRODUCT (including all component parts, the media and printed materials, any upgrades and this EULA), and provided the recipient agrees to the terms of this EULA. If the SOFTWARE PRODUCT is an upgrade, any transfer must also include all prior versions of the SOFTWARE PRODUCT.

f) Termination - Without prejudice to any other rights, DSC may terminate this EULA if You fail to comply with the terms and conditions of this EULA. In such event, You must destroy all copies of the SOFTWARE PRODUCT and all of its component parts.

(g) Trademarks - This EULA does not grant You any rights in connection with any trademarks or service marks of DSC or its suppliers.

3. COPYRIGHT - All title and intellectual property rights in and to the SOFTWARE PRODUCT (including but not limited to any images, photographs, and text incorporated into the SOFTWARE PRODUCT), the accompanying printed materials, and any copies of the SOFTWARE PRODUCT, are owned by DSC or its suppliers. You may not copy the printed materials accompanying the SOFTWARE PRODUCT. All title and intellectual property rights in and to the content which may be accessed through use of the SOFTWARE PRODUCT are the property of the respective content owner and may be protected by applicable copyright or other intellectual property laws and treaties. This EULA grants You no rights to use such content. All rights not expressly granted under this EULA are reserved by DSC and its suppliers.

4. EXPORT RESTRICTIONS - You agree that You will not export or re-export the SOFTWARE PRODUCT to any country, person, or entity subject to Canadian export restrictions.

5. CHOICE OF LAW - This Software License Agreement is governed by the laws of the Province of Ontario, Canada.

6. ARBITRATION - All disputes arising in connection with this Agreement shall be determined by final and binding arbitration in accordance with the Arbitration Act, and the parties agree to be bound by the arbitrator's decision. The place of arbitration shall be Toronto, Canada, and the language of the arbitration shall be English.

7. LIMITED WARRANTY

(a) NO WARRANTY - DSC PROVIDES THE SOFTWARE "AS IS" WITHOUT WARRANTY. DSC DOES NOT WARRANT THAT THE SOFTWARE WILL MEET YOUR REQUIREMENTS OR THAT OPERATION OF THE SOFTWARE WILL BE UNINTERRUPTED OR ERROR-FREE.

(b) CHANGES IN OPERATING ENVIRONMENT - DSC shall not be responsible for problems caused by changes in the operating characteristics of the HARDWARE, or for problems in the interaction of the SOFTWARE PRODUCT with non-DSC-SOFTWARE or HARDWARE PRODUCTS.

(c) LIMITATION OF LIABILITY; WARRANTY REFLECTS ALLOCATION OF RISK - IN ANY EVENT, IF ANY STATUTE IMPLIES WARRANTIES OR CONDITIONS NOT STATED IN THIS LICENSE AGREEMENT, DSC'S ENTIRE LIABILITY UNDER ANY PROVISION OF THIS LICENSE AGREEMENT SHALL BE LIMITED TO THE GREATER OF THE AMOUNT ACTUALLY PAID BY YOU TO LICENSE THE SOFTWARE PRODUCT AND FIVE CANADIAN DOLLARS (CAD\$5.00). BECAUSE SOME JURISDICTIONS DO NOT ALLOW THE EXCLUSION OR LIMITATION OF LIABILITY FOR CONSEQUENTIAL OR INCIDENTAL DAMAGES, THE ABOVE LIMITATION MAY NOT APPLY TO YOU.

(d) DISCLAIMER OF WARRANTIES - THIS WARRANTY CONTAINS THE ENTIRE WARRANTY AND SHALL BE IN LIEU OF ANY AND ALL OTHER WARRANTIES, WHETHER EXPRESSED OR IMPLIED (INCLUDING

ALL IMPLIED WARRANTIES OF MERCHANTABILITY OR FITNESS FOR A PARTICULAR PURPOSE) AND OF ALL OTHER OBLIGATIONS OR LIABILITIES ON THE PART OF DSC. DSC MAKES NO OTHER WARRANTIES. DSC NEITHER ASSUMES NOR AUTHORIZES ANY OTHER PERSON PURPORTING TO ACT ON ITS BEHALF TO MODIFY OR TO CHANGE THIS WARRANTY, NOR TO ASSUME FOR IT ANY OTHER WARRANTY OR LIABILITY CONCERNING THIS SOFTWARE PRODUCT.

(e) EXCLUSIVE REMEDY AND LIMITATION OF WARRANTY - UNDER NO CIRCUMSTANCES SHALL DSC BE LIABLE FOR ANY SPECIAL, INCIDENTAL, CONSEQUENTIAL OR INDIRECT DAMAGES BASED UPON BREACH OF WARRANTY, BREACH OF CONTRACT, NEGLIGENCE, STRICT LIABILITY, OR ANY OTHER LEGAL THEORY. SUCH DAMAGES INCLUDE, BUT ARE NOT LIMITED TO, LOSS OF PROFITS, LOSS OF THE SOFTWARE PRODUCT OR ANY ASSOCIATED EQUIPMENT, COST OF CAPITAL, COST OF SUBSTITUTE OR REPLACEMENT EQUIPMENT, FACILITIES OR SERVICES, DOWN TIME, PURCHASERS TIME, THE CLAIMS OF THIRD PARTIES, INCLUDING CUSTOMERS, AND INJURY TO PROPERTY.

WARNING: DSC recommends that the entire system be completely tested on a regular basis. However, despite frequent testing, and due to, but not limited to, criminal tampering or electrical disruption, it is possible for this SOFTWARE PRODUCT to fail to perform as expected.

FCC Compliance Statement

This equipment generates and uses radio frequency energy and if not installed and used properly, in strict accordance with the manufacturer's instructions, may cause interference to radio and television reception. It has been type tested and found to comply with the limits for Class B device in accordance with the specifications in Subpart "B" of Part 15 of FCC Rules, which are designed to provide reasonable protection against such interference in any residential installation. However, there is no guarantee that interference will not occur in a particular installation. If this equipment does cause interference to television or radio reception, which can be determined by turning the equipment off and on, the user is encouraged to try to correct the interference by one or more of the following measures:

- Re-orient the receiving antenna
- Relocate the alarm control with respect to the receiver
- Move the alarm control away from the receiver
- Connect the alarm control into a different outlet so the alarm control & receiver are on different circuits.

If necessary, the user should consult the dealer or an experienced radio/television technician for additional suggestions. The user may find the following booklet prepared by the FCC helpful: "How to Identify and Resolve Radio/Television Interference Problems". This booklet is available from the U.S. Government Printing Office, Washington, D.C. 20402, Stock # 004-000-00345-4.

IC Statement

This device complies with Industry Canada license-exempt RSS standard(s). Operation is subject to the following two conditions: (1) this device may not cause interference, and (2) this device must accept any interference, including interference that may cause undesired operation of the device.

Le présent appareil est conforme aux CNR d'Industrie Canada applicables aux appareils radio exempts de licence. L'exploitation est autorisée aux deux conditions suivantes : (1) l'appareil ne doit pas produire de brouillage, et (2) l'utilisateur de l'appareil doit accepter tout brouillage radioélectrique subi, même si le brouillage est susceptible d'en compromettre le fonctionnement.

This Class B digital apparatus meets all requirements of the Canadian interference-causing equipment regulations.

Cet appareil numérique de la Classe B respecte toutes les exigences de règlement sur le matériel brouilleur du Canada.

IC:160A-HS2HOST9.

The term 'IC:' before the radio certification number only signifies that Industry Canada technical specifications were met.

EU Compliance Statement

The Model HSM2HOST8 Wireless Transceiver has been certified by Telefication according to EN50131-1:2006 + A1:2009 and EN50131-3:2009, for Grade 2, Class II.

- ① **Note:** For EN50131 compliant installations only, the intrusion portion of the alarm system has been investigated. Fire Alarm and Auxiliary (Medical) Alarm functions were not included in the evaluation of this product under the requirements of the above mentioned standards.

© 2020 Johnson Controls. All rights reserved. Johnson Controls, Tyco and DSC are trademarks of Johnson Controls.

www.dsc.com

The trademarks, logos, and service marks displayed on this document are registered in the United States [or other countries]. Any misuse of the trademarks is strictly prohibited and Tyco will aggressively enforce its intellectual property rights to the fullest extent of the law, including pursuit of criminal prosecution wherever necessary. All trademarks not owned by Tyco are the property of their respective owners, and are used with permission or allowed under applicable laws. Product offerings and specifications are subject to change without notice. Actual products may vary from photos. Not all products include all features. Availability varies by region; contact your sales representative.

